

Dorset County Council**Wildlife and Countryside Act 1981****Dorset County Council
County of Dorset Definitive Map and Statement of Rights of Way****Dorset County Council (Bridleway 7, Piddletrenthide to be Upgraded to
Restricted Byway)
Definitive Map and Statement Modification Order 2015**

This Order is made by Dorset County Council under section 53(2)(b) of the Wildlife and Countryside Act 1981 ("the Act") because it appears to that authority that the County of Dorset Definitive Map and Statement require modification in consequence of the occurrence of an event specified in section 53(3)(c)(ii) namely, that a highway shown in the map and statement as a highway of a particular description ought to be there shown as a highway of a different description and section 53(3)(c)(iii) namely, that any other particulars contained in the map and statement require modification.

The authority have consulted with every local authority whose area includes the land to which the order relates. The Dorset County Council hereby order that:

1. For the purposes of this order the relevant date is 1 January 2015.
2. The County of Dorset Definitive Map and Statement shall be modified as described in Part I and Part II of the Schedule and shown on the map attached to the Order.
3. This order shall take effect on the date it is confirmed and may be cited as the "Dorset County Council (Bridleway 7, Piddletrenthide to be Upgraded to Restricted Byway) Definitive Map and Statement Modification Order 2015".

SCHEDULE

(The points specified relate to the map attached to the Order and their positions are identified by national grid references)

Part I

Modification of definitive map Description of way to be upgraded

Bridleway 7, Piddletrenthide in the West Dorset District:

A – B – C From its junction with the C97 road, south west of Little Platt at point A (ST 71360209), north west along a chalk surfaced track, hedged on the eastern side, to its junction with Footpath 38 at point B (ST 71220224) and continuing generally north north west along the track, to the west of Fetchum Wood, to its junction with the current Bridleway 6, Alton Pancras at the parish boundary at point C (ST 71130264). Width: 9.14 metres (as set out in the 1825 Plush Inclosure Award). Limitation: Field gate at point C (ST 71130264) to BS5709:2006.

Part II

Modification of definitive statement Variation of particulars of way

Bridleway 7, Piddletrenthide

Delete:

From: 713020 To: 711026
Plush to Alton Pancras parish boundary at Watcombe Plain.

Add:

Restricted Byway 7, Piddletrenthide

From: ST 71360209 To: ST 71130264
From its junction with the C97 road, south west of Little Platt, north west along a chalk surfaced track, hedged on the eastern side, to its junction with Footpath 38 at ST 71220224 and continuing generally north north west along the track, to the west of Fetchum Wood, to its junction with Restricted Byway 6, Alton Pancras at the parish boundary.
Width: 9.14 metres (as set out in the 1825 Plush Inclosure Award). Limitation: Field gate at ST 71130264 to BS5709:2006.

Dated this 6TH day of FEBRUARY 2015

THE COMMON SEAL OF THE
DORSET COUNTY COUNCIL
was fixed in the presence of:-

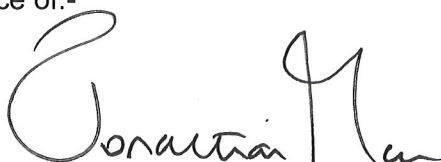

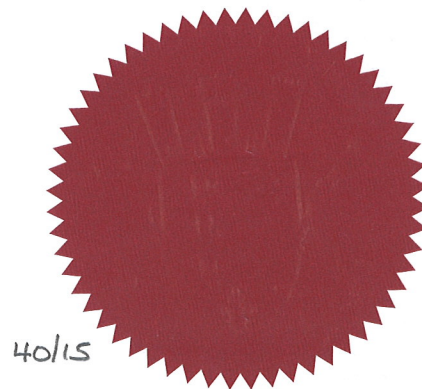

40/15
Authorised Signatory

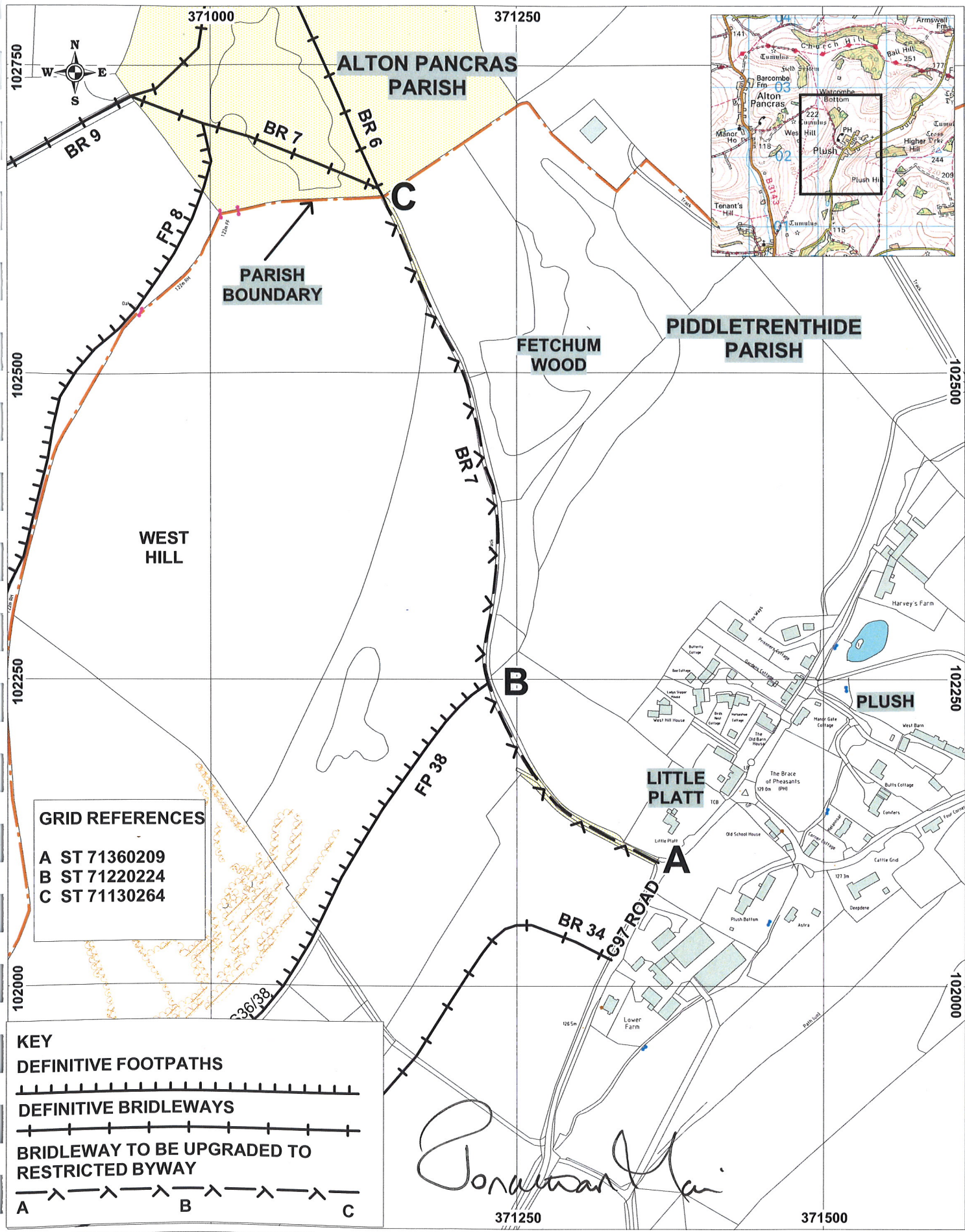

DORSET COUNTY COUNCIL (BRIDLEWAY 7, PIDDLETRENTHIDE TO BE UPGRADED TO RESTRICTED BYWAY) DEFINITIVE MAP AND STATEMENT MODIFICATION ORDER 2015

Ref: 12/11/2
Date: 11/12/2014
Scale 1:4000
Drawn By: KJS
Cent X: 371225
Cent Y: 102300

GEOGRAPHICAL INFORMATION SYSTEMS



© UKPerspectives 2002 & © Getmapping 2005 & 2009
 © Crown Copyright 2015. OS Licence Number 100019790